



One stop commercial  
kitchen equipment  
solutions



## POLYURETHANE PANELS



Protect the Health of your Business  
and the Hygiene of your Industries

**FOOD-TECH SOLUTIONS (M) SDN BHD (853487-K)**

*Office Address: No 92-94-96, Jalan Mutiara Barat*

*Off Jalan Cheras, Taman Tayton*

*56000, Kuala Lumpur, Malaysia.*

*Tel : 603- 9130 1266 Fax : 603-9130 8266*

*E-mail : [fts@afe.com.my](mailto:fts@afe.com.my) / [w.boey@afe.com.my](mailto:w.boey@afe.com.my)*



One stop commercial  
kitchen equipment  
solutions

## Product Description

REMAN panel is a lightweight, structural, continuously manufactured insulated sandwich panel with a range of thicknesses of internal & external skins of colorbond steel laminated to a core of expanded polyurethane insulation.

REMAN panel is available in a range of thickness, length, with a standard width of 1200 mm with either flat or ribbed surface finish with of white colors.

REMAN insulated panel doors are manufactured in a wide range of types, slide, hinged, up lift, bi part any type is achievable. All doors are manufactured using many of REMAN exclusively designed extrusions, tracks rollers, guides, locks, handles, gaskets etc to a extremely high quality finish all heavy duty construction.

## Applications

REMAN panels & insulated doors are all made to order to suit a wide range of applications for the construction, food processing & cold storage industries. Typical uses are for freezers, coolroom's, clean rooms, portable cold room, food production, walls, ceilings & partitions.

REMAN manufactures & installs insulated panels, insulated doors to order & with all materials such as extrusions, fixings, sealants, for a complete project. REMAN can supply complete kit form rooms with all components ready for installation.

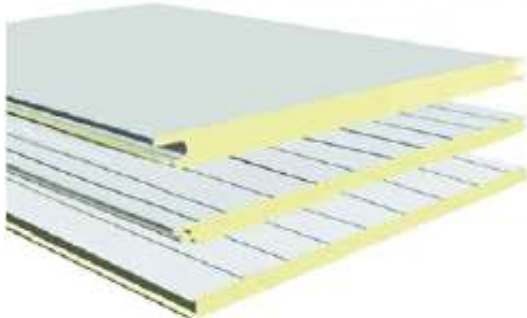

### Thicknesses

50mm, 75mm,  
100mm, 125mm  
and 150mm,

### Cold Room Material

Color Bond  
Stainless Steel  
Aluminium Stucco Emboss

## Cold Room Reference



# Panel Joining System

We have a wide range of superior quality joints to speed up the installation of ceiling, floors & walls. Typical examples of these joints are illustrated below.

Mitre Joint

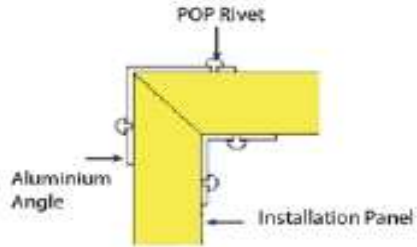

Suspension Joint

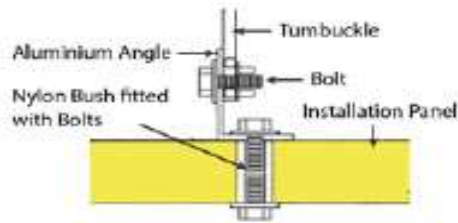

Floor Joint

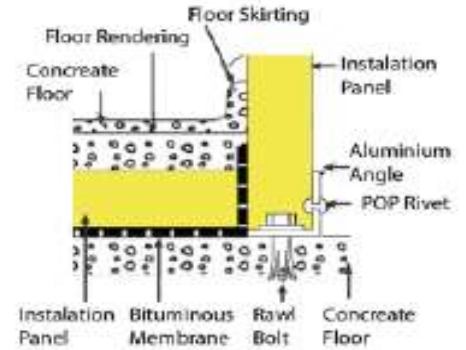

'H' Bar Joint

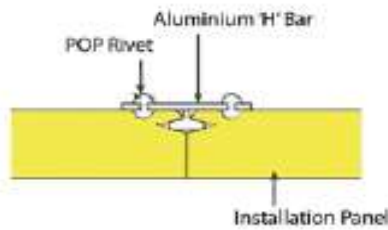

Cam-Lock Joint

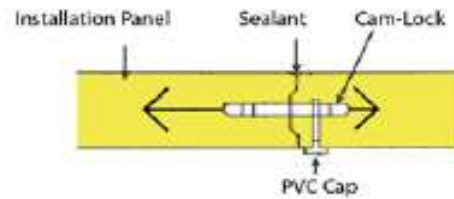

## Hanging Profile & Suspension

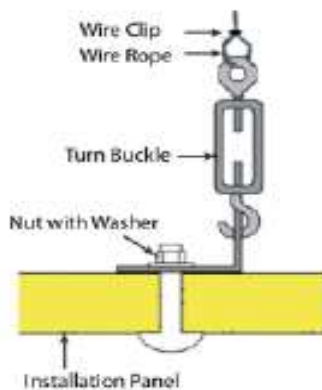

Aluminium Curved Hanging Profile for Ceiling Panel to Panel Joint Suspension

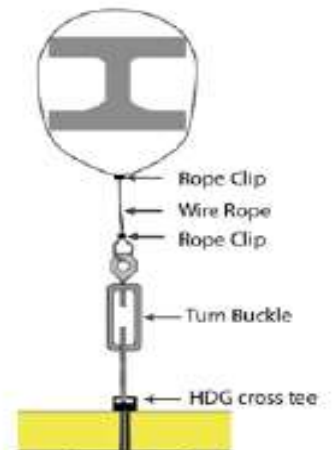
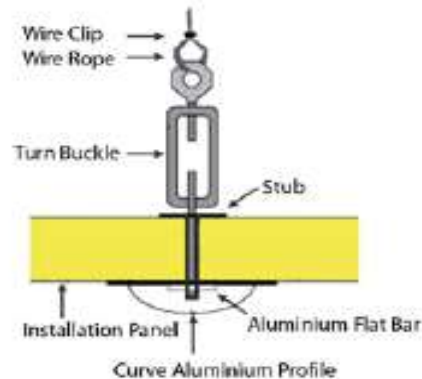

## Specifications

Typical Physical Properties		
Property	Units	Polyurethane
Injected Density	kg /m <sup>3</sup>	40 - 45
Thermal Conductivity	kcal/m/hr/°C	0.018 - 0.020
Compression Strength	kg /cm <sup>2</sup>	1.7 - 2.2
Modulus of Elasticity	kg /cm <sup>2</sup>	40 - 70
Shearing Strength	kg /cm <sup>2</sup>	1.7 - 2.1
Breaking Elongation		5 - 10%
Water Vapour Transfer	α23°C	30 - 60
Water Absorption	Δp/V%	1.7 - 2.3
Closed Cells		90 - 95%
Operation Temperature		-60 - +80°C

## Type of Door

